

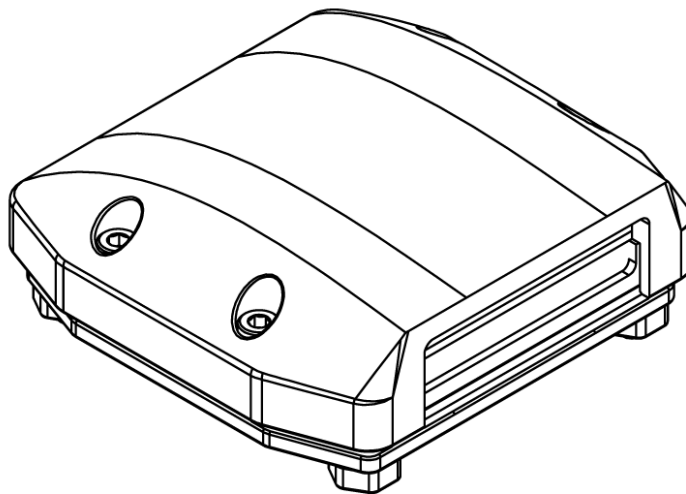

CopperStar USA LLC.



NOVA Series Installation Guide.



Notice:

These instructions assume prior knowledge and experience with fabrication and mechanical ability. Read all instructions and inventory all parts and assemblies included with this product.

It is advised that installation is performed by a CopperStar USA LLC. installer or equally qualified individual for a quality installation.

Tools Recommended for Installation:

- 7/8" Metal Hole Saw
 - 1/8" Drill
- Double Cut Metal File
 - Metal Air Saw
 - Center Punch
 - Hammer
 - Deburring Tool
 - Masking Tape
 - Measuring Tape
- Set of Metric Hex Drive Wrenches
(Allen Wrenches)

Parts and Assemblies

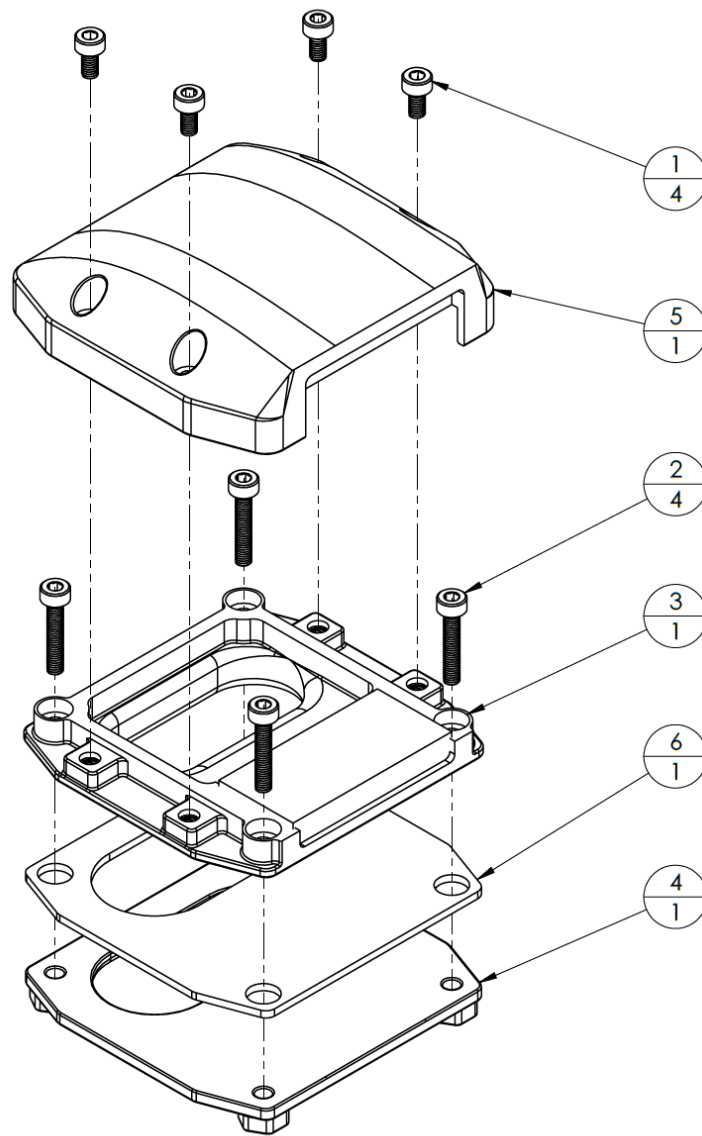

Item No.	Part	Qty.
1	M3 X 6MM Stainless Steel Socket Head Cap Screw	4
2	M3 X 16MM Stainless Steel Socket Head Cap Screw	4
3	NOVA Base Assembly	1
4	NOVA Base Support Assembly	1
5	NOVA Cap Assembly	1
6	NOVA Surface Gasket	1

1. Layout and Measure

- a. Mark out the location and hole patterns using the template supplied at the end of this installation guide. Ensure that the proper orientation of the NOVA is observed. The foam gland is facing rearward to the direction of travel (noted on template)

2. Cutting Hole Pattern

- a. Use a center punch to mark the centers of the holes.
- b. Use the 7/8" hole saw and 1/8" drill in the indicated location(s) on the template.

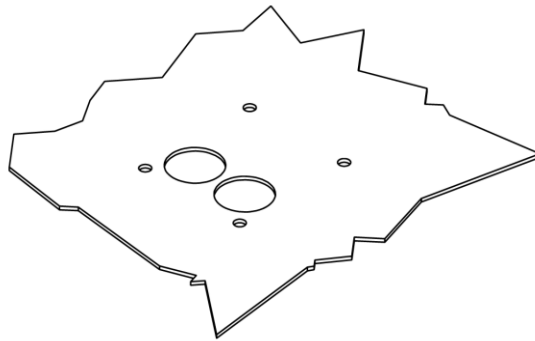

- c. Cut away the remaining material between the holes made by the hole saw. (Skip this step for the Mini NOVA)

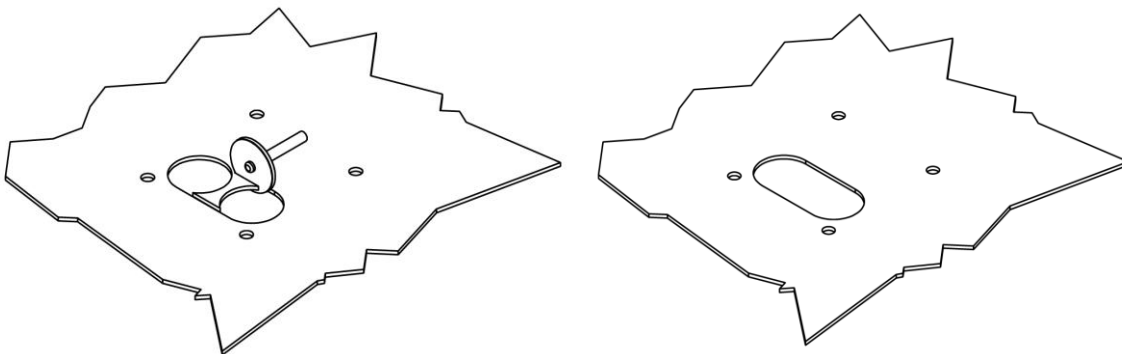

- d. Deburr all edges with a file or deburring tool.

3. Mounting NOVA Base

- a. Place the NOVA Surface Gasket and the Nova Base Assembly onto the panel and place the M3 X 16MM Socket Head Cap Screws through the base and the sheet metal as shown below.

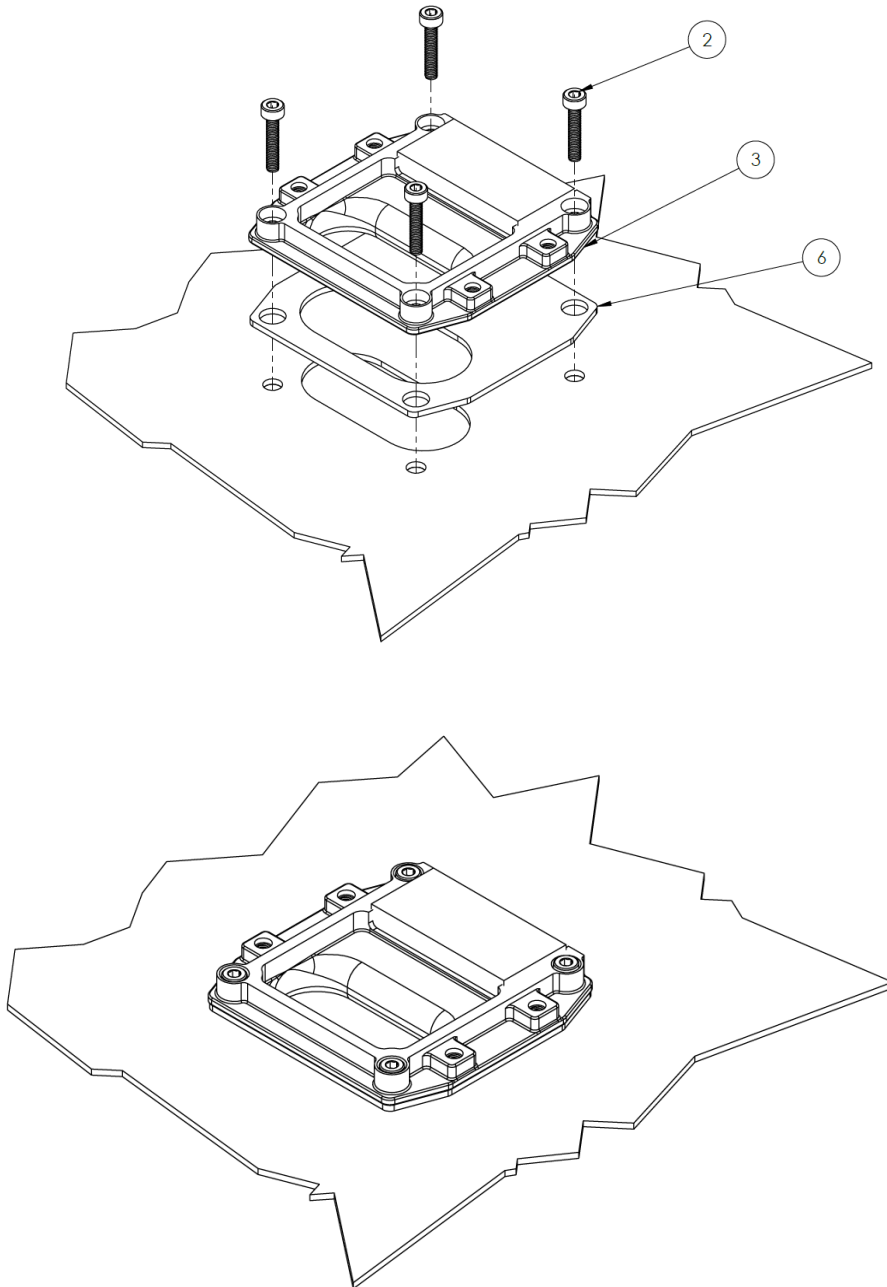

- b. Place the Base Support Assembly on the bottom of the sheet metal and drive the screws in from the top. Assure that the Base Support Assembly sits flush with the surface of the sheet metal. DO NOT OVER TIGHTEN screws, tighten screws until the Base Support Assembly is fully seated and the screws are snug.

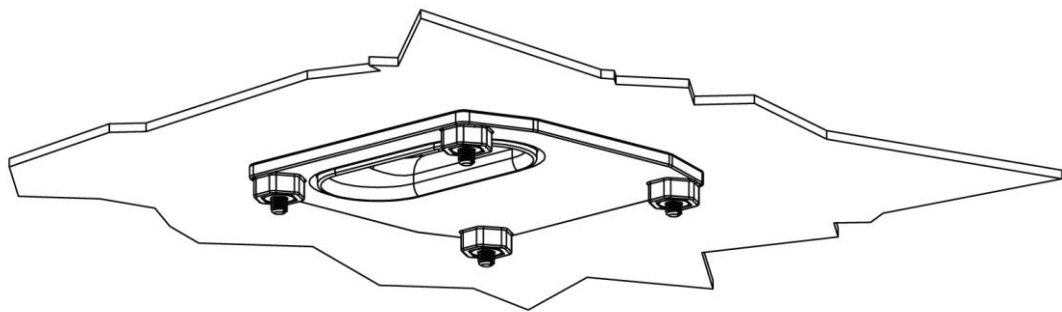
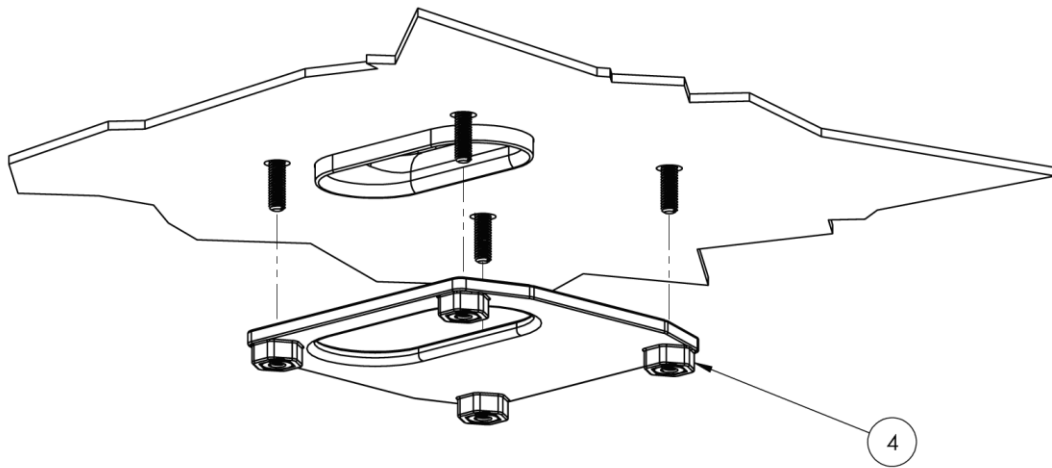

4. Sealing and Finishing

- a. Pull your wires and cables through the NOVA and route them as needed for the use.
- b. Apply sealant to the mating lip of the NOVA. Apply the sealant around the wires and cables about half-way from the inner and outer edges of the foam gasket stripping.

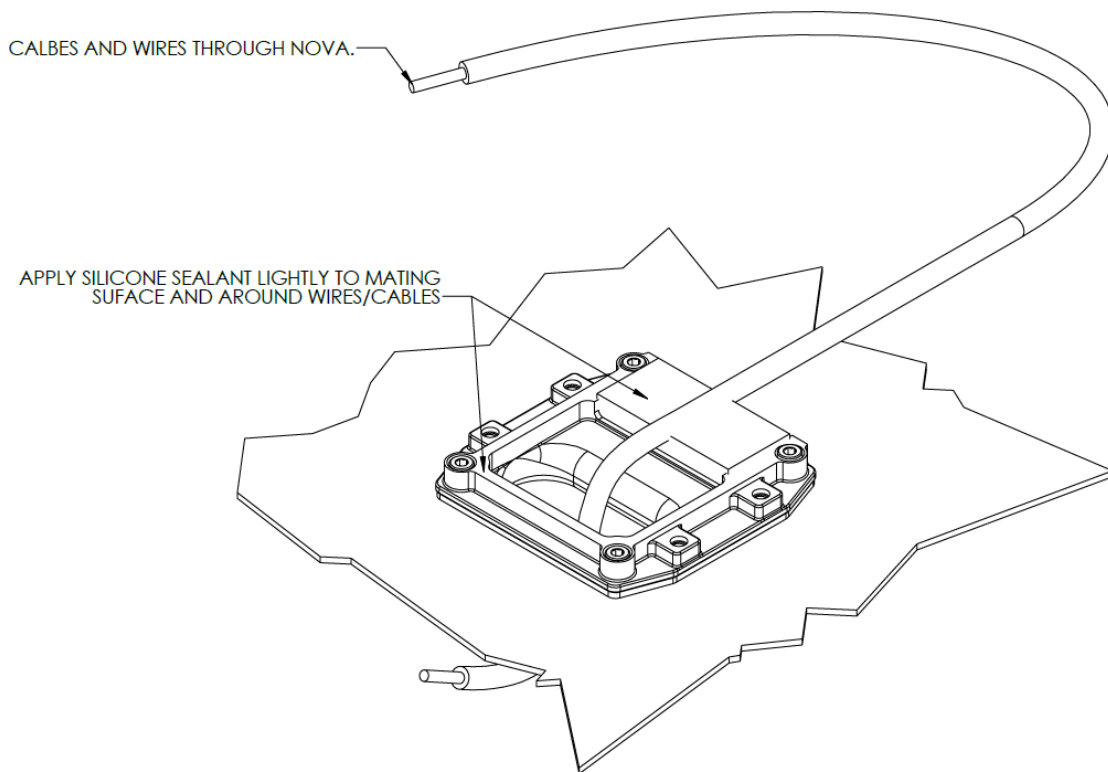

- c. Place the NOVA Cap Assembly on the NOVA Base Assembly and screw down the cap using the M3 X 6MM Socket Head Cap Screws. DO NOT OVER TIGHTEN the screws, tighten until snug and NOVA Cap Assembly is fully seated.

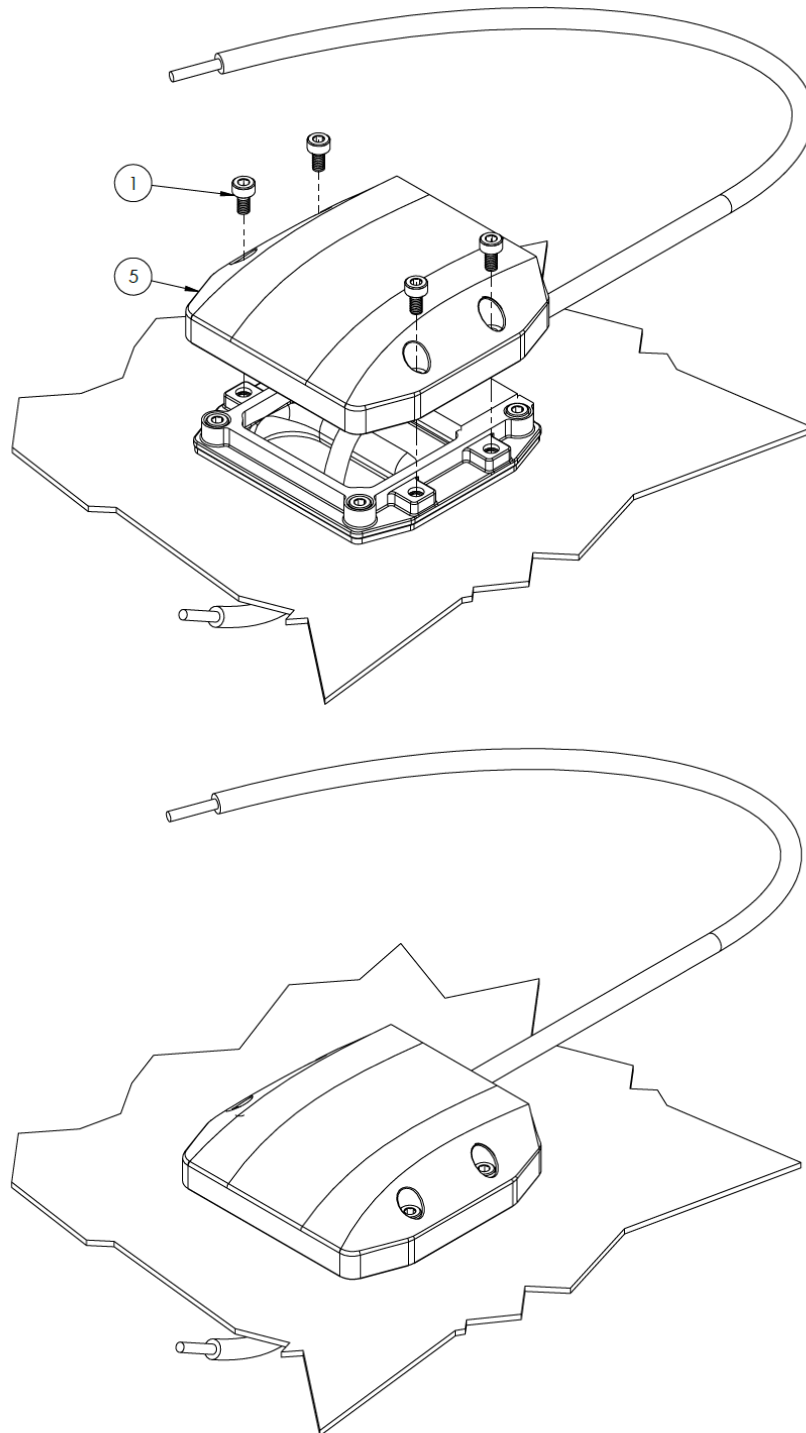



B

A

B

A

